

## DHR

### MULTISTAGE CENTRIFUGAL PUMPS

Low energy consumption, Extremely silent, Impellers and diffusers made of stainless steel AISI 304, Threaded ports set for oval fittings (range DHR 9)

The DHR series pumps are horizontal centrifugal pumps, not self-priming. All the rotating parts that come into contact with the pumped liquid are made of stainless steel AISI 304.

#### USAGE DATA

- Type of liquid: clean water without suspended solids or abrasive material.
- Maximum temperature of the liquid 90°C.
- Maximum ambient temperature 50° C
- Maximum recommended intake height: 6 m with foot valve (with temperature of the liquid at 50° C)
- Maximum operating pressure: 10 bar (with temp. of liquid 50°C) 6 bar (with temp. of liquid 90°C)

#### APPLICATIONS

- Lifting and distribution of water in domestic systems in continuous or intermittent operation.
- Pressurization systems.
- Washing, irrigation, gardens, fountains.

#### MOTOR

- Closed, ventilated from exterior.
- Degree of protection IP 54.
- Insulation class F.
- Single-phase power supply with capacitor permanently on and thermal protection built into the motor casing.
- Three-phase power supply with external protection provided by the user.
- Speed of rotation 2850 rpm.
- Continuous service.
- Maximum ambient temperature 50°C



## TABLE OF MATERIALS

Component	Material
1 Intake and supply flange	Cast iron GJL 200 (ASTM Class 35)
2 Motor body	Cast aluminium
3 Impellers	Stainless steel X5CrNi18-10 (AISI 304)
4 Diffusers:	Stainless steel X5CrNi18-10 (AISI 304)
5 Sleeve	Stainless steel X5CrNi18-10 (AISI 304)
6 Shaft (part in contact with water)	Stainless steel X5CrNi18-10 (AISI 304)
7 Gaskets	NBR
8 Mechanical seal	Ceramic / Graphite / NBR

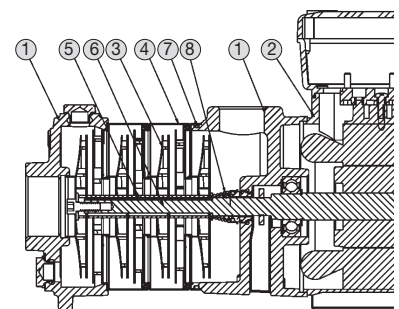

# DHR 2 - DHR 4

## MULTISTAGE CENTRIFUGAL PUMPS

### HYDRAULIC PERFORMANCE

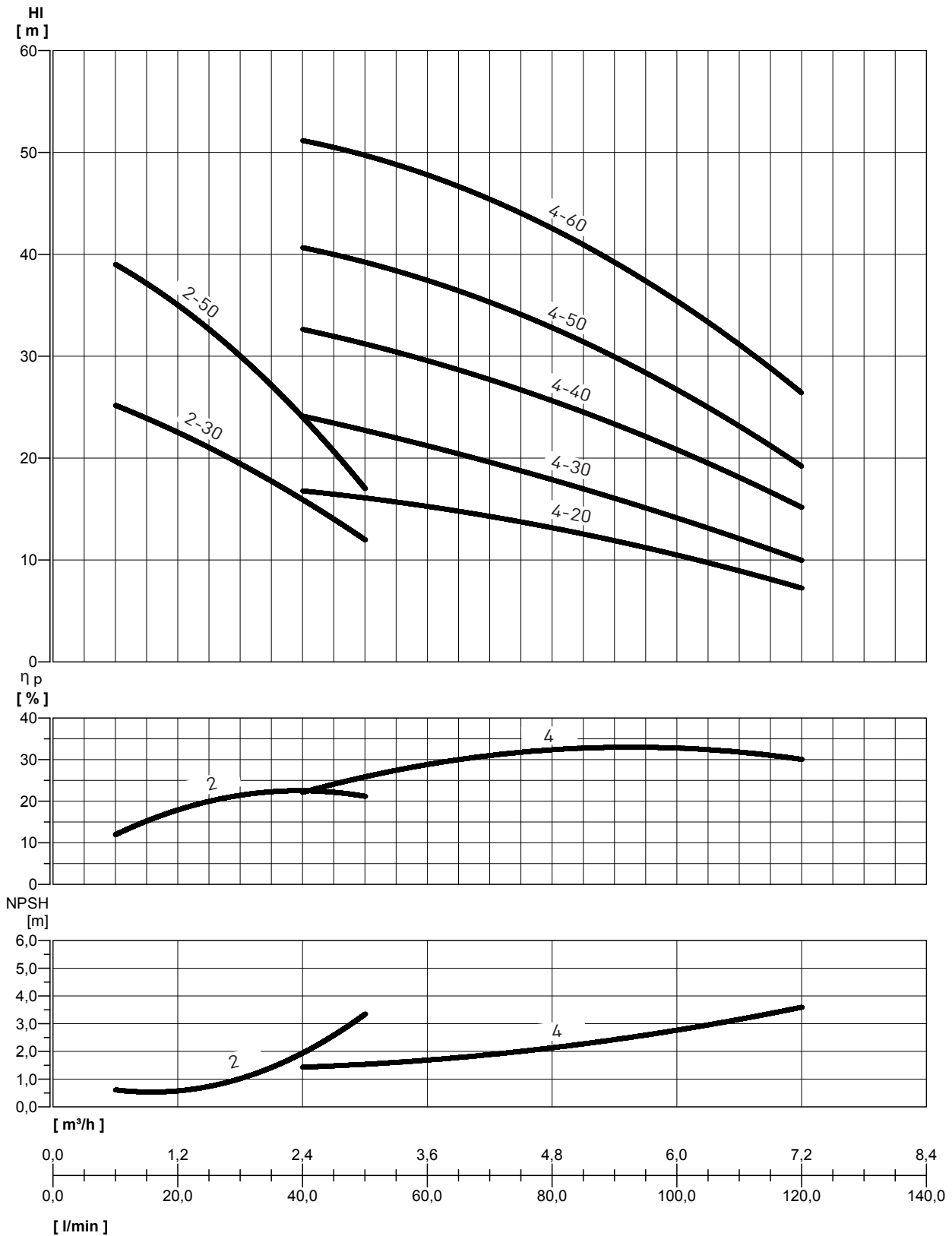

# DHR 2 - DHR 4

## MULTISTAGE CENTRIFUGAL PUMPS

### PERFORMANCE TABLE

MODEL	Nominal power (P2)		Absorbed power (P1)		VOLT. (V)	In (A)	μF.	0	L/min	10	20	30	40	50
	HP	kW	HP	kW					m³/h	0,6	1,2	1,8	2,4	3
DHR 2-30 M	0,40	0,30	0,7	0,52	1~230	2,6	12,5	m.c.w.	25	23	19	16	12	
DHR 2-30 T	0,40	0,30	0,67	0,50	3~230/400	1,9-1,1	-		25	23	19	16	12	
DHR 2-50 M	0,67	0,50	1	0,75	1~230	3,5	12,5		39	35	30	24	17	
DHR 2-50 T	0,67	0,50	1	0,75	3~230/400	2,5-1,8	-		39	35	30	24	17	

MODEL	Nominal power (P2)		Absorbed power (P1)		VOLT. (V)	In (A)	μF.	0	L/min	40	50	60	80	100	120
	HP	kW	HP	kW					m³/h	2,4	3	3,6	4,8	6	7,2
DHR 4-20 M	0,50	0,37	0,75	0,55	1~230	2,7	12,5	m.c.w.	17	16	15	13	11	7	
DHR 4-20 T	0,50	0,37	0,78	0,58	3~230/400	2,1-1,2	-		17	16	15	13	11	7	
DHR 4-30 M	0,67	0,50	1,10	0,80	1~230	3,7	12,5		24	23	21	18	14	10	
DHR 4-30 T	0,67	0,50	1	0,75	3~230/400	2,5-1,4	-		24	23	21	18	14	10	
DHR 4-40 M	0,94	0,70	1,34	1	1~230	4,5	16		33	31	29	26	21	15	
DHR 4-40 T	0,94	0,70	1,34	1	3~230/400	3,2-1,9	-		33	31	29	26	21	15	
DHR 4-50 M	1,20	0,90	1,68	1,25	1~230	5,8	20		41	39	37	33	27	19	
DHR 4-50 T	1,20	0,90	1,55	1,15	3~230/400	3,4-2	-		41	39	37	33	27	19	
DHR 4-60 M	1,6	1,2	2	1,5	1~230	7	31,5		52	49	47	43	36	26	
DHR 4-60 T	1,6	1,2	2	1,5	3~230/400	5,4-3,1	-		52	49	47	43	36	26	

# DHR 2 - DHR 4

## MULTISTAGE CENTRIFUGAL PUMPS

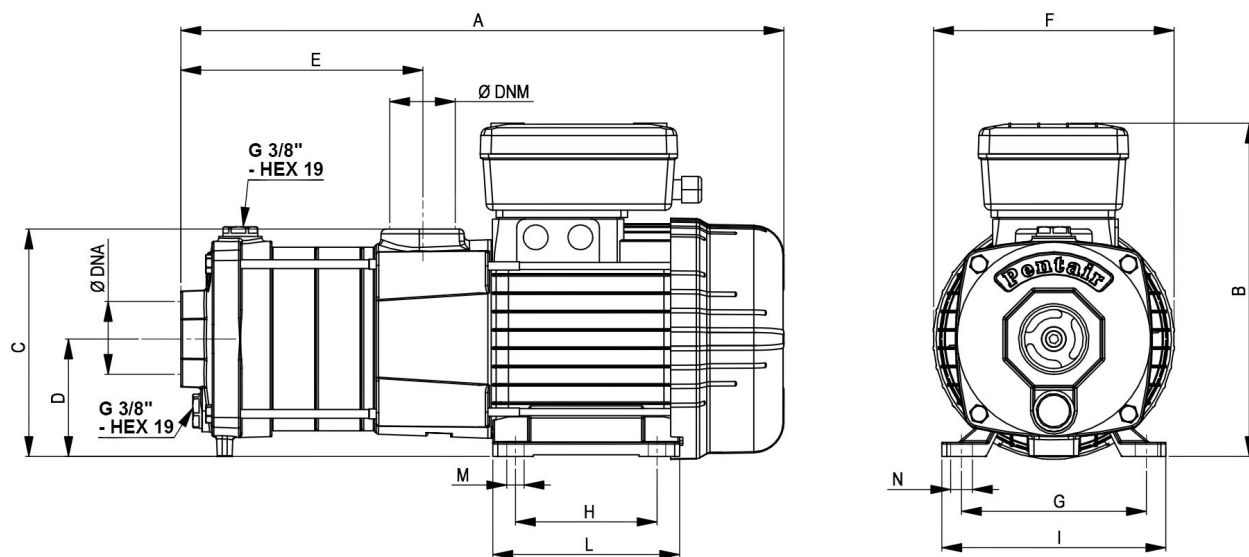

### OVERALL DIMENSIONS AND WEIGHTS

MODEL	Dimensions in mm.														WEIGHT (Kg)
	A	B	C	D	E	F	G	H	I	L	M	N	DNA	DNM	
DHR 2-30 M	326	205	137,5	71	105	142	112	90	135	112	7,5	12	1"	1"	10,2
DHR 2-30 T	326	190	137,5	71	105	142	112	90	135	112	7,5	12	1"	1"	
DHR 2-50 M	362	205	137,5	71	141	142	112	90	135	112	7,5	12	1"	1"	11,5
DHR 2-50 T	362	190	137,5	71	141	142	112	90	135	112	7,5	12	1"	1"	
DHR 4-20 M	339	205	137,5	71	119	142	112	90	135	112	7,5	12	1" 1/4	1"	10,5
DHR 4-20 T	339	190	137,5	71	119	142	112	90	135	112	7,5	12	1" 1/4	1"	
DHR 4-30 M	339	205	137,5	71	119	142	112	90	135	112	7,5	12	1" 1/4	1"	10,7
DHR 4-30 T	339	190	137,5	71	119	142	112	90	135	112	7,5	12	1" 1/4	1"	
DHR 4-40 M	366	205	137,5	71	146	142	112	90	135	112	7,5	12	1" 1/4	1"	12
DHR 4-40 T	366	190	137,5	71	146	142	112	90	135	112	7,5	12	1" 1/4	1"	
DHR 4-50 M	394	205	137,5	71	173	142	112	90	135	112	7,5	12	1" 1/4	1"	13,9
DHR 4-50 T	394	190	137,5	71	173	142	112	90	135	112	7,5	12	1" 1/4	1"	
DHR 4-60 M	445	230	149	80	200	160	125	100	153	125	9	13	1" 1/4	1"	17
DHR 4-60 T	445	209	149	80	200	160	125	100	153	125	9	13	1" 1/4	1"	

# DHR 9

## MULTISTAGE CENTRIFUGAL PUMPS

### HYDRAULIC PERFORMANCE

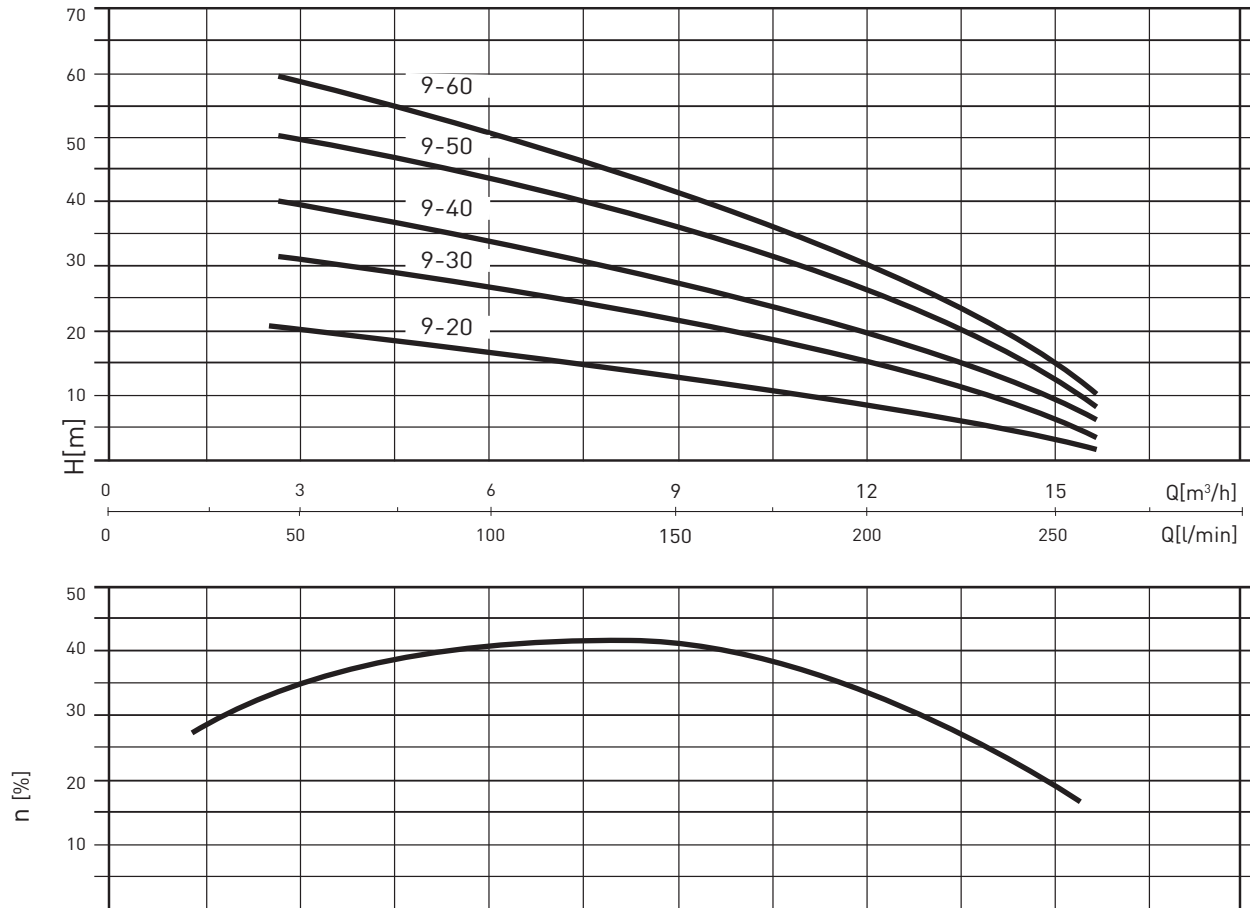

### PERFORMANCE TABLE

MODEL	Nominal power (P2)		Absorbed power (P1)		VOLT. (V)	In (A)	μF.	0	m.c.w.							
	HP	kW	HP	kW					l/min	40	80	120	160	200	240	260
									m³/h	2,4	4,8	7,2	9,6	12	14,4	15,6
DHR 9-20 M	0,87	0,65	1,34	1	1~230	4,5	20		20	19	16	13	9	5	3	
DHR 9-20 T	0,87	0,65	1,21	0,9	3~230/400	3-1,7			20	19	16	13	9	5	3	
DHR 9-30 M	1,27	0,95	1,88	1,4	1~230	6	25		31	29	26	21	16	9	5	
DHR 9-30 T	1,27	0,95	1,81	1,35	3~230/400	4,4-2,5			31	29	26	21	16	9	5	
DHR 9-40 M	1,74	1,3	2,41	1,8	1~230	8	31,5		40	38	33	27	19	10	5	
DHR 9-40 T	1,74	1,3	2,15	1,6	3~230/400	5,3-3			40	38	33	27	19	10	5	
DHR 9-50 M	2,15	1,6	2,95	2,2	1~230	10	35		51	49	43	36	26	14	6	
DHR 9-50 T	2,15	1,6	2,68	2	3~230/400	6,1-3,5			51	49	43	36	26	14	6	
DHR 9-60 T	2,55	1,9	3,35	2,5	3~230/400	7,9-4,5			60	56	49	40	29	14	6	

# DHR 9

## MULTISTAGE CENTRIFUGAL PUMPS

### OVERALL DIMENSIONS AND WEIGHTS

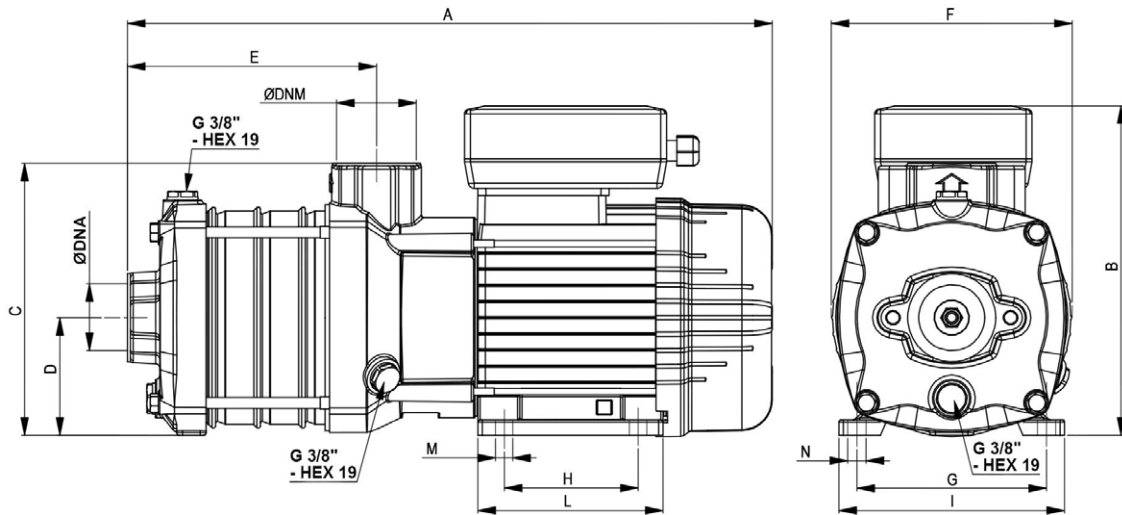

### OVERALL DIMENSIONS AND WEIGHTS

MODEL	Dimensions in mm.														WEIGHT (Kg)
	A	B	C	D	E	F	G	H	I	L	M	N	DNA	DNM	
DHR 9-20 M	378	227	185	80	107	160	125	100	153	125	9	13	1" ½	1" ¼	19,2
DHR 9-20 T	378	196	185	80	107	160	125	100	153	125	9	13	1" ½	1" ¼	17,5
DHR 9-30 M	378	227	185	80	107	160	125	100	153	125	9	13	1" ½	1" ¼	20,0
DHR 9-30 T	378	196	185	80	107	160	125	100	153	125	9	13	1" ½	1" ¼	19,1
DHR 9-40 M	408	227	185	80	137	160	125	100	153	125	9	13	1" ½	1" ¼	21,5
DHR 9-40 T	408	196	185	80	137	160	125	100	153	125	9	13	1" ½	1" ¼	20,1
DHR 9-50 M	438	227	185	80	168	160	125	100	153	125	9	13	1" ½	1" ¼	23,7
DHR 9-50 T	438	196	185	80	168	160	125	100	153	125	9	13	1" ½	1" ¼	22,0
DHR 9-60 T	468	196	185	80	198	160	125	100	153	125	9	13	1" ½	1" ¼	24,0