

VERSAILLES

SUBMERSIBLE PUMPS FOR FOUNTAINS AND WATER FEATURES

The pumps of the VERSAILLES series have been designed for fountains, water features and waterfalls in water gardens.

USAGE DATA

- Type of liquid: clear water without solids.
- Maximum temperature of the liquid 40°C.
- Maximum immersion under the water level 7m.
- Free passage of solids 1.5 mm.
- For water games with smaller passages insert the sponge filter in the hydraulic part (optional).

MOTOR

- Dry motor with stainless steel body
- Degree of protection IP 68
- Insulation class F
- Single-phase power supply with capacitor always on.
- Thermal protection built into the motor casing.
- Cable connection chamber completely insulated.
- Self-lubricating ball bearings.
- Speed of rotation 2850 rpm.
- Suitable for continuous use.

APPLICATIONS

- Installation of fountains, water features, waterfalls in water parks.

OPTIONAL ACCESSORIES

- Vulcano: water game with water jets at three levels.
- Geyser: water game with one adjustable bubbling jet of water.
- Bell: water game in the shape of a bell, adjustable.
- Filters: spongy material, passages smaller than 1.5 mm to be used for all water games.



VULCANO

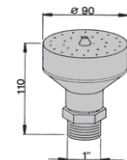

GEYSER

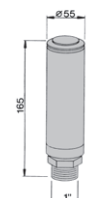

BELL

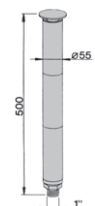

TABLE OF MATERIALS

Component	Material
Air inlet grille	Stainless steel X 5 CrNiS 1810 (AISI 304)
Base	Stainless steel X 5 CrNiS 1810 (AISI 304)
Pump body	Stainless steel X 5 CrNiS 1810 (AISI 304)
Impeller	Stainless steel X5 CrNi 1810 (AISI 304) casting
Supply cable	10m H07 RN-F with plug
Seal	Double fixed seal in rubber NBR 70 with special V-ring sand guard
Motor shaft	Stainless steel X 12 CrS 13 (AISI 416) with ceramic insert at the points of wear of the seal
Reducer 1" F	Plastic material

VERSAILLES

SUBMERSIBLE PUMPS FOR FOUNTAINS AND WATER GAMES

HYDRAULIC PERFORMANCE

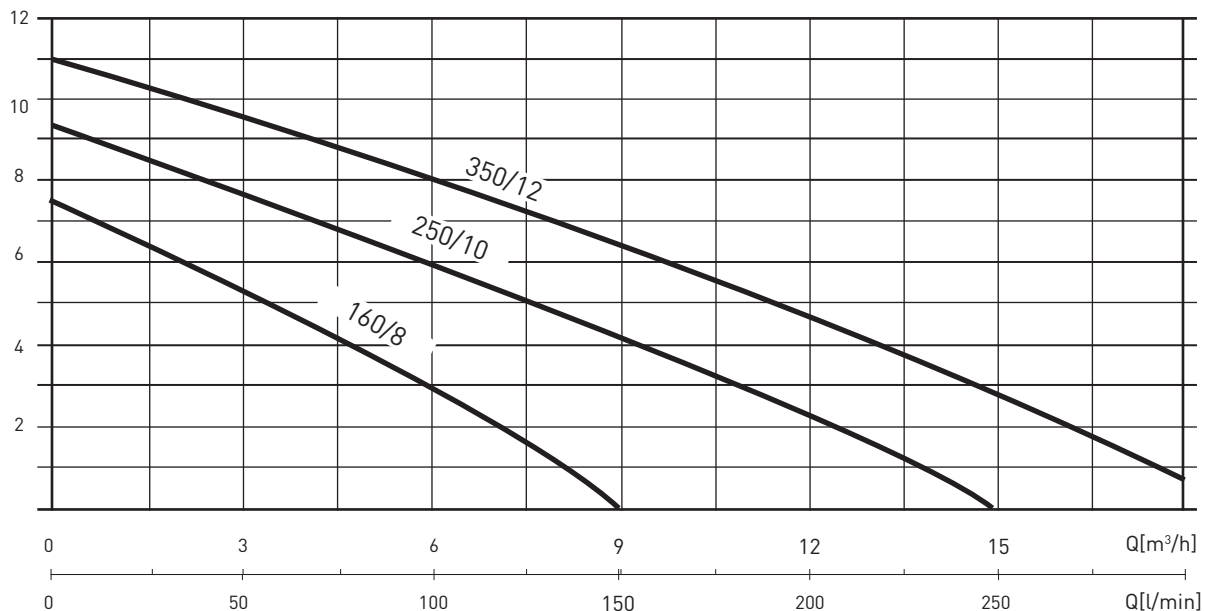

MODEL	Motor power (P2)		Motor power (P1)		VOLT (V)	I _n (A)	μF	Q l/min	Diameter and height of water games in cm		
	HP	kW	HP	kW					VULCANO	GAISER	CAMPANA
VERSAILLES 160/8	0,5	0,37	0,6	0,45	1~230	2,2	8		Ø 180 - H 360	Ø 20 - H 110	Ø 90 - H 45
VERSAILLES 250/10	0,75	0,5	0,9	0,7	1~230	4,5	10	m.c.w.	Ø 200 - H 420	Ø 30 - H 180	Ø 95 - H 45
VERSAILLES 350/12	1,1	0,8	1,6	1,2	1~230	5,1	16		Ø 200 - H 480	Ø 50 - H 230	Ø 100 - H 45

VULCANO

GAISER

CAMPANA

FILTER 1 FOR MOD. 80/7 - 160/8

FILTER 2 FOR MOD. 250/10 - 350/12

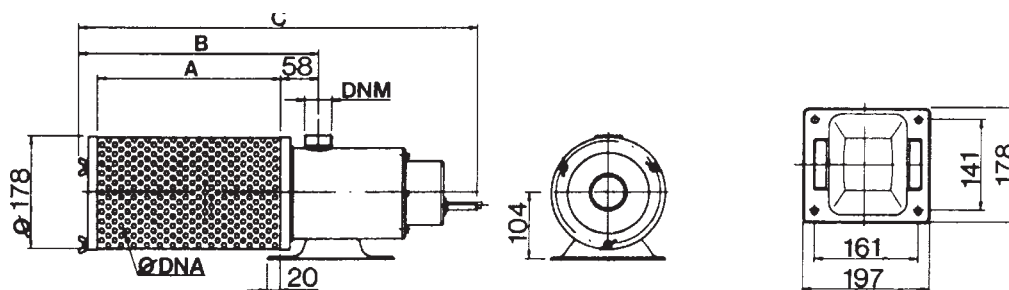

OVERALL DIMENSIONS AND WEIGHTS

MODEL	Dimensions mm.					WEIGHT (Kg)
	A	B	C	P.L.	DNM	
VERSAILLES 160/8	144	231	425	Ø 1,5	1" 1/4	7
VERSAILLES 250/10	285	372	620	Ø 1,5	1" 1/4	7,8
VERSAILLES 350/12	285	372	620	Ø 1,5	1" 1/4	9,3