

DOMINATOR 4 PLUS

MULTISTAGE CENTRIFUGAL SUBMERSIBLE PUMP FOR CLEAR WATER Ø 4"

Double mechanical seal, hydraulic system particularly resistant to the corrosive action of sand, integrated non-return valve

DOMINATOR 4 Plus submersible pumps with double mechanical seal are suitable for installations in traditional wells, water deposits, collection tanks, clear watercourses, lakes, etc. Nylon suspension rope (20m) included.

APPLICATIONS

- Lifting of water from traditional wells.
- Installations in tanks inside homes for the pressurization of systems.
- Small automatic systems for garden irrigation.
- Surface irrigation.

USAGE DATA

- Type of liquid: clean water without suspended solids or abrasive material.

- Maximum temperature of the liquid 40°C.
- Maximum immersion under the water level 17 m.

MOTOR

- Dry motor with stainless steel body cooled by pumped liquid.
- Degree of protection IP 68
- Insulation class F.
- Single-phase power supply with capacitor always on.
- Thermal protection built into the motor casing.
- Cable connection chamber completely insulated.
- Self-lubricating ball bearings.
- Speed of rotation 2850 rpm.
- Suitable for continuous use.



TABLE OF MATERIALS

Component	Material
1 Non-return valve	Thermoplastic with NBR o-ring integrated
2 Pump body	Stainless steel Europe: EN10088-1 X 5 CrNi 1810 (1.4301) Usa: AISI 304
3 Mechanical seal - oil chamber fixed part	Aluminium oxide / NBR
4 Mechanical seal - oil chamber rotating part	Stainless steel Europe: EN10088-1 X 5 CrNi 1810 (1.4301) Usa: AISI 304 / NBR / Resin-impregnated carbon graphite
5 Mechanical seal - fixed part	Aluminium oxide / NBR
6 Mechanical seal - rotating part	Stainless steel Europe: EN10088-1 X 2 CrNiMo 17-12-2 (1.4404) USA: AISI 316 / NBR / Carbon graphite
7 Motor shaft	Immersion part - Europe: EN10088-1 X 8 CrNiS 18-9 (1.4305) USA: AISI 303/ Motor side - carbon steel
8 Diffuser cap	Polycarbonate with stainless steel insert Europe: EN10088-1 X 5 CrNi 1810 Usa: AISI 304 (1.4301)
9 Diffuser	Polycarbonate with ceramic insert
10 Impeller	Acetal resin
11 Bushing	Stainless steel Europe: EN10088-1 X 8 CrNiS 18-9 (1.4305) USA: AISI 303 with ceramic coating
12 Bearing	Self-lubricating Nylatron®
13 Intake filter	Stainless steel Europe: EN10088-1 X 6 Cr 17 (1.4016) USA: AISI 430
14 Base	PPO - Noryl™ GFN 2
- Supply cable	Type H07 RN-F - length 20 m
-	Thrust ring in each stage

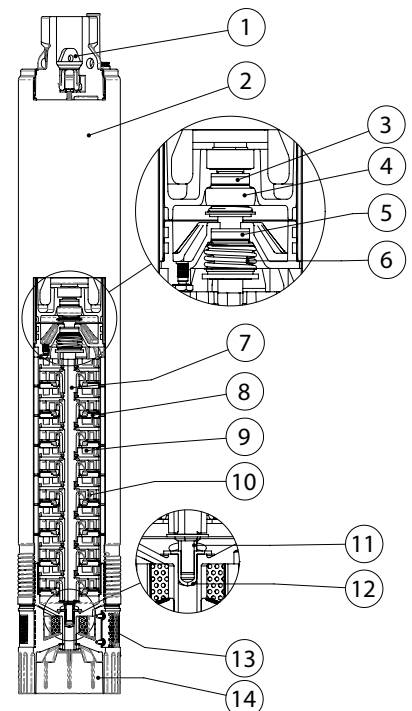

DOMINATOR 4 PLUS

MULTISTAGE CENTRIFUGAL SUBMERSIBLE PUMP FOR CLEAR WATER Ø 4"

HYDRAULIC PERFORMANCE

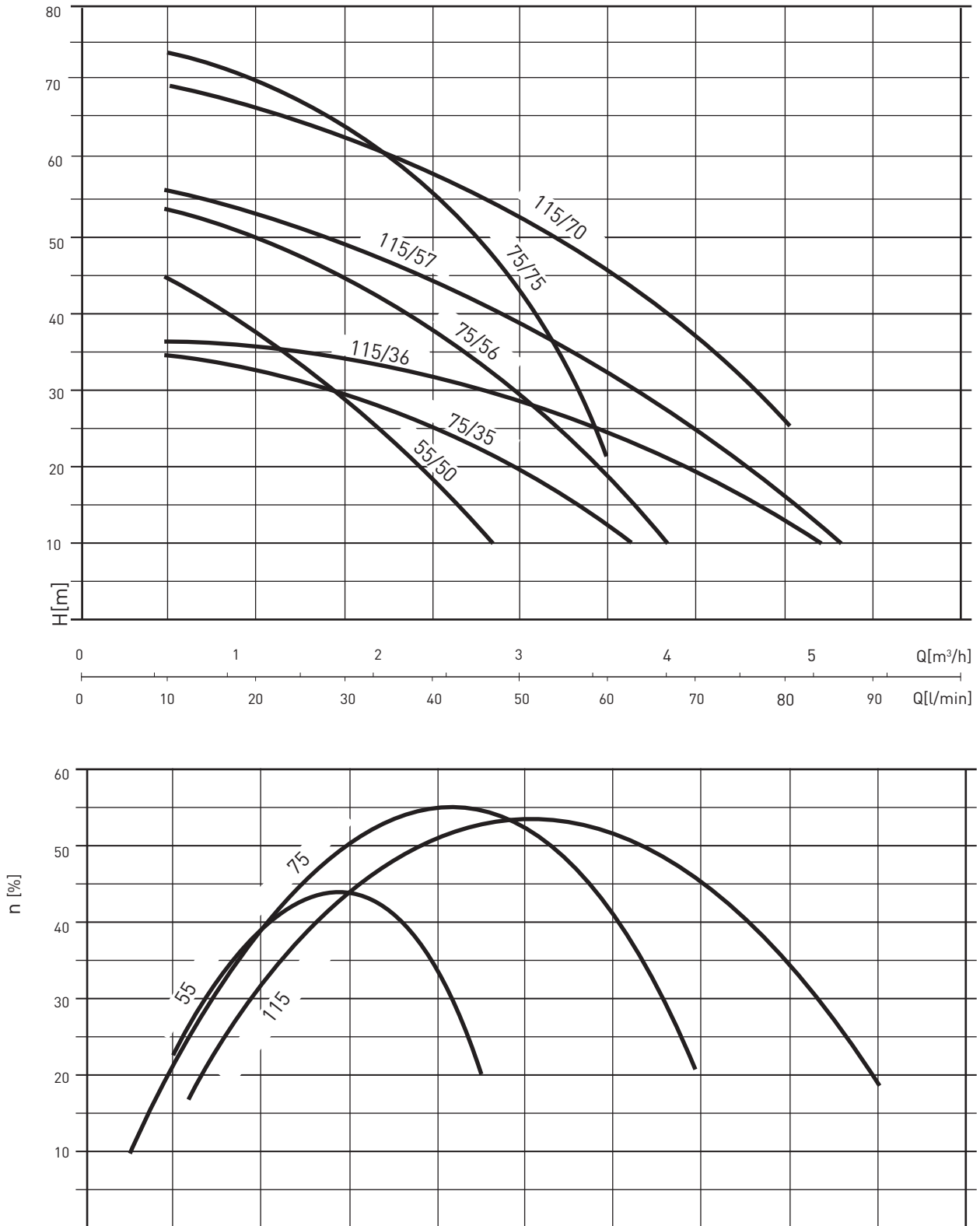

DOMINATOR 4 PLUS

MULTISTAGE CENTRIFUGAL SUBMERSIBLE PUMP FOR CLEAR WATER Ø 4"

PERFORMANCE TABLE

MODEL	Motor power (P2)		Motor power (P1)		VOLT. (V)	In (A)	µF	Stadi Stages	Ø	m.c.w.				
	HP	kW	HP	kW						l/min	0	20	40	60
										0	1,2	2,4	3,6	4,8
DOMINATOR 4 PLUS 55/50 M	0,75	0,56	1,1	0,8	1~230	3,8	16	6		50	38,7	17		
DOMINATOR 4 PLUS 75/35 M	0,50	0,35	0,80	0,60	1~230	3	12,5	5		35	33	26	11	
DOMINATOR 4 PLUS 75/56 M	0,80	0,60	1	0,75	1~230	3,3	16	8		56	48,9	38,1	19	
DOMINATOR 4 PLUS 75/75 M	0,95	0,7	1,5	1,1	1~230	5	20	11		75	70	53	21,6	
DOMINATOR 4 PLUS 115/36 M	0,55	0,40	1	0,75	1~230	3,5	12,5	5		36	35	32	25	13
DOMINATOR 4 PLUS 115/57 M	1	0,8	1,50	1,10	1~230	5	16	8		57	52	44,4	31,5	16,6
DOMINATOR 4 PLUS 115/70 M	1,1	0,8	1,8	1,3	1~230	6	20	10		70	65	59	45,4	27

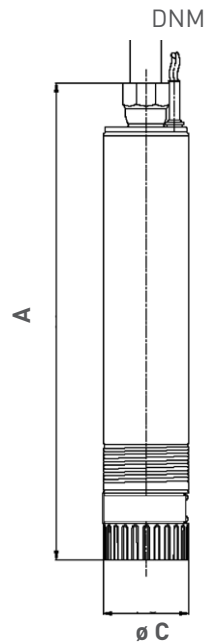

OVERALL DIMENSIONS AND WEIGHTS

MODEL	Dimensions mm.				WEIGHT (Kg)
	A	Ø C	Free passage	DNM	
DOMINATOR 4 PLUS 55/50 M	549	98	2 mm	1"1/4	10,4
DOMINATOR 4 PLUS 75/35 M	560	98	2 mm	1"1/4	10,2
DOMINATOR 4 PLUS 75/56 M	643	98	2 mm	1"1/4	10,8
DOMINATOR 4 PLUS 75/75 M	760	98	2 mm	1"1/4	12,5
DOMINATOR 4 PLUS 115/36 M	560	98	2 mm	1"1/4	10,2
DOMINATOR 4 PLUS 115/57 M	643	98	2 mm	1"1/4	10,8
DOMINATOR 4 PLUS 115/70 M	732	98	2 mm	1"1/4	12,5